

**SERIAL NO. 2278647
 THRU 2399397.**

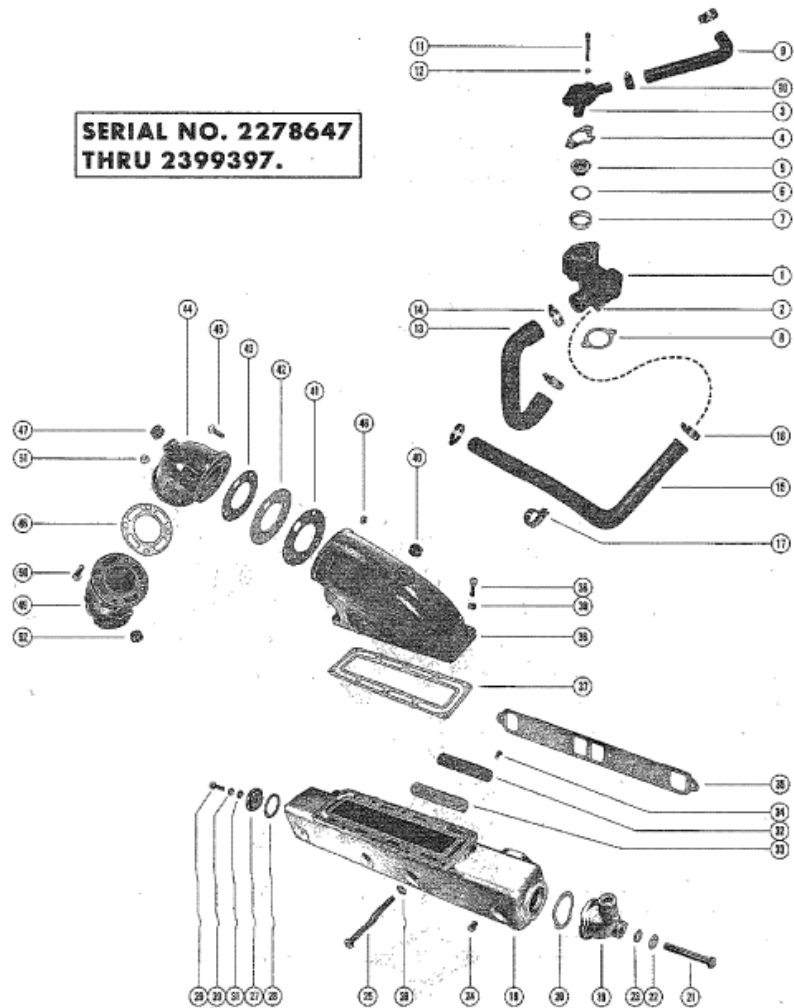

Parts List						
Ref	Class	Part	Description	Qty	Comment	Footnote
1		49965A 2	THERMOSTAT HOUSING ASSEM	1		
2	233	47511	SLEEVE, THERMOSTAT HOUSI	1		
3		47441	COVER, THERMOSTAT HOUSI	1		
4	27	47509	GASKET, THERMOSTAT HSG. I	1	SERIAL 02278647-02399197	
4	27	48818	GASKET, THERMOSTAT HSG. I	1	SERIAL 02399198-02399397	
5		35884	THERMOSTAT	1		
6	27	47510	GASKET, THERMOSTAT (MIDDLE)	1		
7	23	47508	SLEEVE, THERMOSTAT HOUSI	1		
8	27	33179	GASKET, THERMOSTAT HOUSI	1		
9	32	35567	HOSE, THERMOSTAT HOUSING	2		
10	54	32880	CLAMP, HOSE TO THERMOSTAT	4		
11	10	35785	SCREW, THERMOSTAT HOUSI	2		
12	13	37459	LOCKWASHER, THERMOSTAT H	2		
13	323	33189	HOSE, THERMOSTAT HOUSING	1		
14	54	32781	CLAMP, HOSE THERMOSTAT HC	2		
15	32	47684	HOSE, OIL COOLER TO THERMO	1	SERIAL 02278647-02399197	
15	32	49044	HOSE, WATER PUMP TO THERM	1	SERIAL 02399198-02399397	
16	54	32780	CLAMP, HOSE TO OIL COOLER A	2		
17	54	47715	CLIP, HOSE TO CYLINDER BLOC	1		
18		37297	EXHAUST MANIFOLD (PROT ANE	2		
19		36306	HOUSING, WATER INLET - EXHA	2		
20	27	33180	GASKET, WATER INLET HOUSIN	2		
21	10	31827	SCREW, WATER INLET HOUSIN	2		
22	12	20553	WASHER, WATER INLET HOUSI	2		
23	12	33181	WASHER, COPPER - WATER INL	2		
24	22	32802	PULG. PIPE - EXHAUST MANIFOL	2		
25	10	33389	SCREW, EXHAUST MANIFOLD TI	8		
26	12	20553	WASHER, EXHAUST MANIFOLD	8		
27		35298A 1	END CAP ASSEMBLY, EXHAUST	2		
28	27	33180	GASKET END CAP	2		
29	10	28464	SCREW, END CAP TO EXHAUS	2		
30	12	20553	WASHER, END CAP SCREW	2		
31	12	33181	WASHER, COPPER - END CAP	2		
32		33183	COVER, CHOKE OVEN - STARBO.	1	SERIAL 02399198-02399397	
33	27	33184	GASKET, CHOKE OVEN COVER	1	SERIAL 02399198-02399397	
34	10	22022	SCREW, CHOKE COVER TO EXH.	2	SERIAL 02399198-02399397	
35	27	33395	GASKET, EXHAUST MANIFOLD T	2		
36		37298	ELBOW, EXHAUST MANIFOLD	2		
37	27	37296	GASKET, EXHAUST MANIFOLD E	2		
38	10	37258	SCREW, EXHAUST MANIOLD ELI	20		
39	11	28270	NUT, EXHAUST MANIFOLD ELRC	20		